

**SINGLE TURN
ABSOLUTE
ENCODER
345**

Absolute miniaturized single turn encoder, from 2 to 8 bits, with built-in electronics, for ultra-miniature applications.
Highly reliable performances, in spite of its miniaturized size, make this encoder ideal for robotic applications.

Absolute single turn
page: 01.345 1/2
data sheet IA002 E00

Measures without tolerance according to UNI ISO 2768-mk

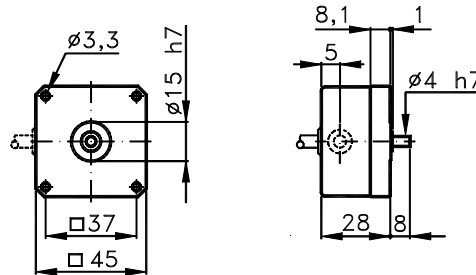

TECHNICAL FEATURES AND POSSIBLE CONFIGURATIONS

- Output codes.....: Gray, Excess, Custom
 - Max pulses/rev.....: 256 (8 bits)
 - Power supply Vcc.....: 5±5%
 - Max consumption.....: 200÷400 mA accord. to bits (*)
 - Light source.....: LED with >= 100000 h life
 - Optical sensors.....: Phototransistors
 - Max frequency.....: 50 kHz (*)
 - Operating temperature.: 0 ÷ +70 °C (*)
 - Storage temperature...: -30 ÷ +85 °C (*)
 - Burn-in @ +75 °C.....: 72 h (*)
 - Up/down commutation...: No
 - Mechanical zero search: No
 - Output stages.....: (-) NPN open coll.10mA(std)
 - Pre output interface...: (-) Parallel (standard)
 - Electronic options.....: (for parallel interf.)
 - Connections Radial (R): CV
Axial (-) (*)
 - For the description of connections see 'ORDERING CODE' on page 2.
 - Base.....: Anodized aluminium (*)
 - Cover.....: Anodized aluminium (*)
 - Weight.....: 100 g
 - Shaft.....: Stainless steel (*)
 - Max.rad/axial load....: 0,5 Kg
 - IP output side.....: see 'CONNECTIONS' on page 2
 - IP shaft side.....: std.64 | sealed 65 | low torq.53
 - Contin. max RPM...(**): 6000 | 3000 | 8000
 - Starting torque.. gcm.: 12 | 25 | 8
 - Impact resistance.....: 50 G (11 ms)
 - Vibration resistance...: 12 G (10 ÷ 2000 Hz)
 - Ball bearings life.....: 1,5x10⁹ revolutions
(@ 1000 rev/m with load of 1/4 maximum allowed)
- (*) Custom options
(**) Intermittent max RPM + 30% of continuous max RPM

POSSIBLE OPTIONS

CODE	DESCRIPTION	CODE	DESCRIPTION	CODE	DESCRIPTION
A	High temperature	X	Custom options	G	Tropicalization
L	Low temperature	H	Different shaft ø	Z	Sealed bal bearing
Y	Unbreakable disk			B	Low torque ball bear.



ELCIS s.r.l. Via Rosa Luxembourg 12/14 10093 COLLEGNO (TO) ITALY
Phone: +39 011 715577/78 r.a.
MAIL: ELCIS s.r.l. P.O.Box 90 10093 COLLEGNO (TO) ITALY

* <http://www.elcis.com>
* e-mail: info@elcis.com
* Fax: +39 011 712613

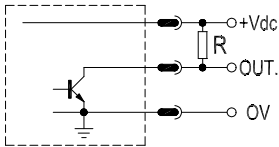
ELECTRONIC OUTPUT	INTERFACE	PARALLEL OPTIONS
» (-) NPN open coll.10mA(std)	» (-) Parallel (standard)	»
	The angular value is present on the output connector in a 'parallel' form. The number of conductors is proportional to the resolution and the type of selected code. Any electronic output stage can be applied.	»
»	»	»
»	»	»
»	»	»

ORDERING CODE

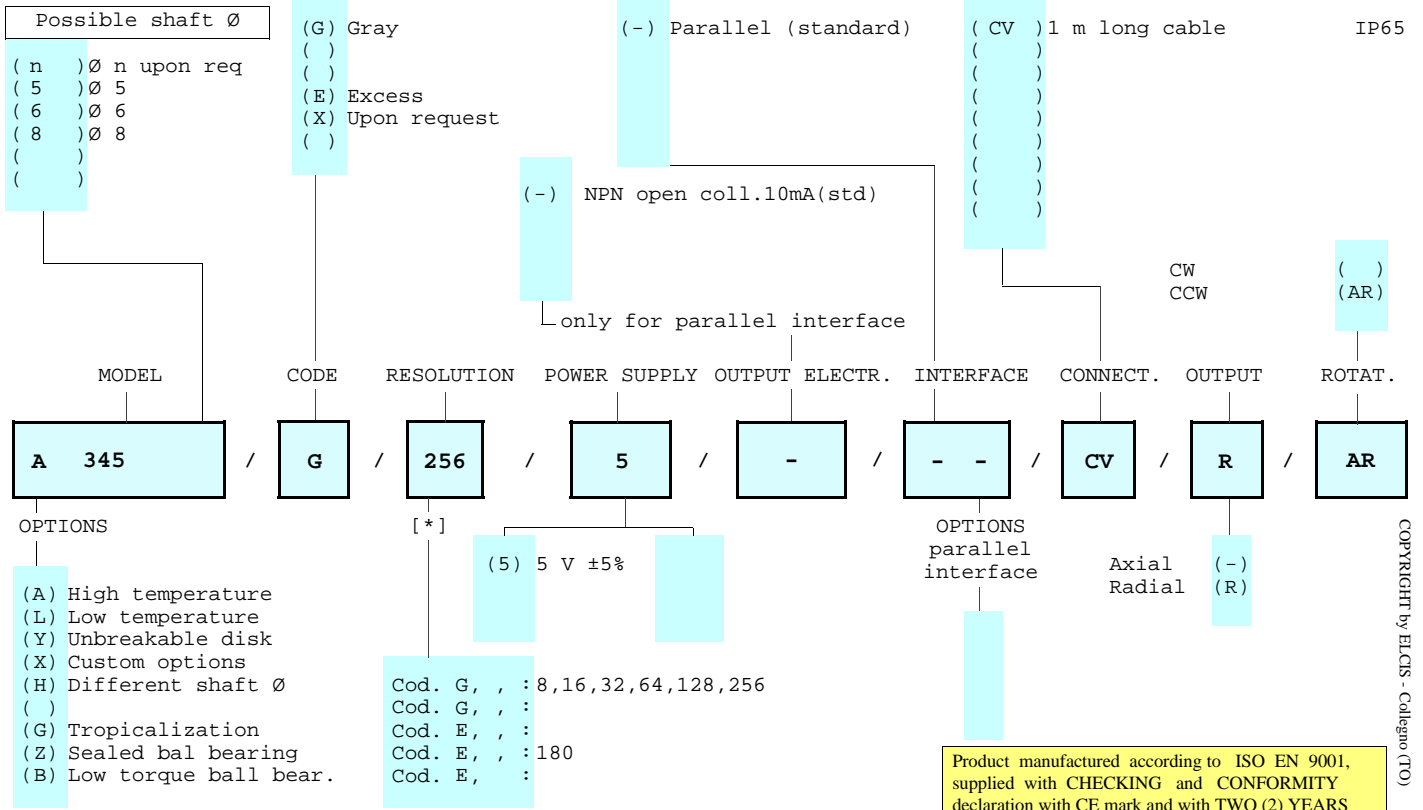

Product manufactured according to ISO EN 9001, supplied with CHECKING and CONFORMITY declaration with CE mark and with TWO (2) YEARS WARRANTY starting from delivery date.

[*] Other resolutions on customer's requirement

	ELCIS s.r.l. Via Rosa Luxembourg 12/14 10093 COLLEGNO (TO) ITALY	* http://www.elcis.com
	Telefono: +39 011 715577/78 r.a.	* e-mail: info@elcis.com
	Corrispondenza: ELCIS s.r.l. P.O.Box 90 10093 COLLEGNO (TO) ITALY	* Fax: +39 011 712613

COPYRIGHT by ELCIS - Collegno (TO)